

TRINITY MEWS, THORNABY, STOCKTON-ON-TEES, TS17 6BQ



- ▲ Offered to the Market with a Chain Free Sale
- ▲ Perfect for a First Time Buyer or Landlord Looking for a Ready to Go Rental
- ▲ Two Bedroom First Floor Apartment
- ▲ L' Shaped Lounge/Diner with Juliet Balcony
- ▲ Kitchen & Bathroom
- ▲ Long Lease

£75,000

www.michaelpoole.co.uk

Michael Poole
sales | lettings | auctions



This two bedroom first floor apartment is situated close to river walks, a 2-3 minute walk from Stockton Riverside College and is well placed for commuting routes. The property also comes with gas central heating with combi boiler, resident parking, and no onward chain.

Comprising lobby, entrance hall with storage, two bedrooms, L' shaped lounge/diner with Juliet balcony, kitchen, and bathroom with white three-piece suite.

GROUND FLOOR

ENTRANCE LOBBY

Entrance via intercom security system with staircase to the first floor.

FIRST FLOOR

ENTRANCE HALL - With wooden entrance door and two storage cupboards.

LOUNGE/DINING ROOM - 5.38m (17'8") reducing to 2.87m (9'5") x 4.17m (13'8") reducing to 2m (6'7")

With two radiators, Juliet balcony and thermostat heating control.

KITCHEN - 2.2m x 2.41m (7'3" x 7'11")

Fitted with a range of white floor and drawer units with complementary work surface, one and a half bowl stainless steel sink with mixer tap and drainer, slot in cooker, space for fridge freezer, electric extractor fan, and tile effect vinyl flooring.

BEDROOM ONE - 3.33m x 2.9m (10'11" x 9'6")

With radiator.

BEDROOM TWO - 3m x 1.96m (9'10" x 6'5")

With radiator.

BATHROOM - Fitted with white three-piece suite comprising panelled bath with electric shower over, vanity unit with wash hand basin, WC, radiator, tile effect vinyl flooring, part tiled walls and electric extractor fan.

TO VIEW: Tel: 01642 763636

Myton Park, Myton Road, Ingleby Barwick, TS17 0WA

www.michaelpoole.co.uk



TRINITY MEWS, TS17 6BQ



AGENTS REF: - MH/LS/ING240035/30012024

Council Tax Band: B **Tenure:** Leasehold

TO VIEW: Contact our Ingleby Barwick office on
Tel: 01642 763636



GROUND FLOOR
499 sq.ft. (46.3 sq.m.) approx.

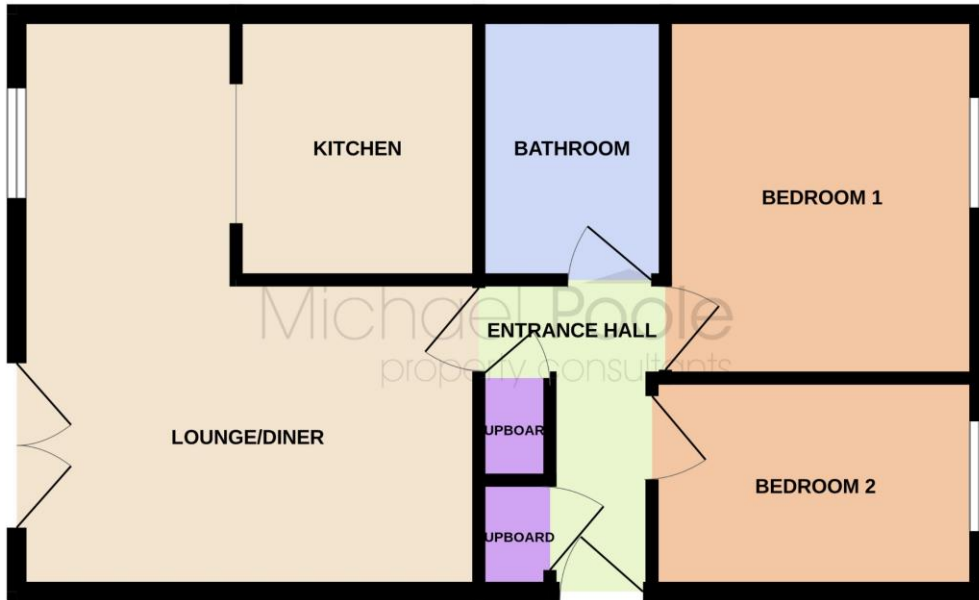

TOTAL FLOOR AREA : 499 sq.ft. (46.3 sq.m.) approx.
 Whilst every attempt has been made to ensure the accuracy of the floorplan contained here, measurements of doors, windows, rooms and any other items are approximate and no responsibility is taken for any error, omission or mis-statement. This plan is for illustrative purposes only and should be used as such by any prospective purchaser. The services, systems and appliances shown have not been tested and no guarantee as to their operability or efficiency can be given.
 Made with Metropix 5/2024

The information provided about this property does not constitute or form part of an offer or contract, nor may it be regarded as representations. All interested parties must verify accuracy and your solicitor must verify tenure and lease information, fixtures and fittings and, where the property has been recently constructed, extended or converted, that planning/building regulation consents are in place. All dimensions are approximate and quoted for guidance only, as are floor plans which are not to scale, and their accuracy cannot be confirmed. Reference to appliances and/or services does not imply that they are necessarily in working order or fit for the purpose. We offer our clients an optional conveyancing service, through panel conveyancing firms, via MWU and we receive on average a referral fee of one hundred and thirty pounds, only on completion of the sale. If you do use this service, the referral fee is included within the amount that you will be quoted by our suppliers. All quotes will also provide details of referral fees payable.

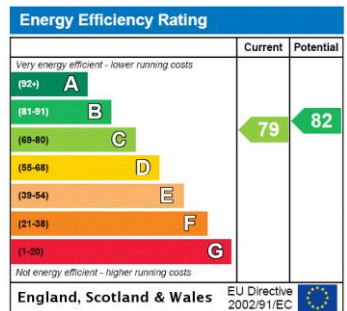

TO VIEW: Contact our Ingleby Barwick Office on Tel: 01642 763636
 Myton Park, Myton Road, Ingleby Barwick, TS17 0WA